

Y strainers

Type M-F821A, G-F821C and H-F821F

O-8.1.11-E

Page 1 of 2

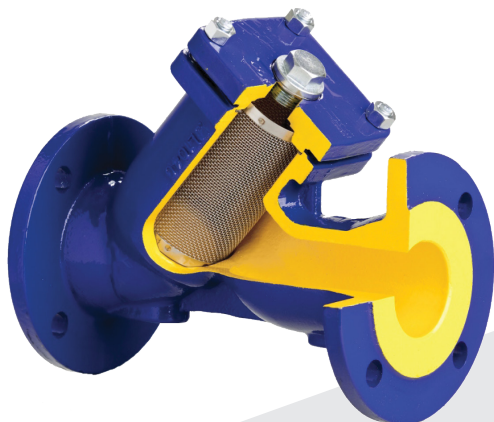

TECHNICAL DATA

Face-to-face dimension according to EN 558-1 series 1
Flanges drilled according to EN 1092-1 for body material F (H-F821F)
Flanges drilled according to EN 1092-2 for body material A (M-F821A), C (G-F821C)
Closing tightness acc. EN 12266-1

APPLICATIONS

Saturated steam, water, oil, air and other compatible fluids.

DESCRIPTION

The Y strainers are applicable to all types of steam, water, oil and air systems. Their purpose is to protect traps, regulating valves, piping, etc. from dirt which often cause damage and consequently energy loss in fluid systems. Connections are flanged.

INSTALLATION

Horizontal or vertical downstream installation.

FEATURES

- Screen made of stainless steel
- Compact settlement
- Environment-friendly
- Cleaning of screen without disassembling

SPECIFICATIONS

Type	Body material	Nominal pressure PN bar	Nominal diameter DN mm	Max temperature °C
M-F821A	A: Grey cast iron	16	15-200	300
G-F821C	C: Nodular cast iron	25		350
H-F821F	F: Cast steel	40		400

SCREENS

Type	Mesh (mm)	
M-F821A	DN 15-50	1
	DN 65-150	1.25
	DN 200	1.6
G-F821C H-F821F	DN 15-50	1
	DN 65-80	1.25
	DN 100-200	1.6

Meshes in 0.6, 0.5, 0.4, 0.32 and 0.2 mm are available on request.

Subject to change without notice.

DIMENSION SKETCH

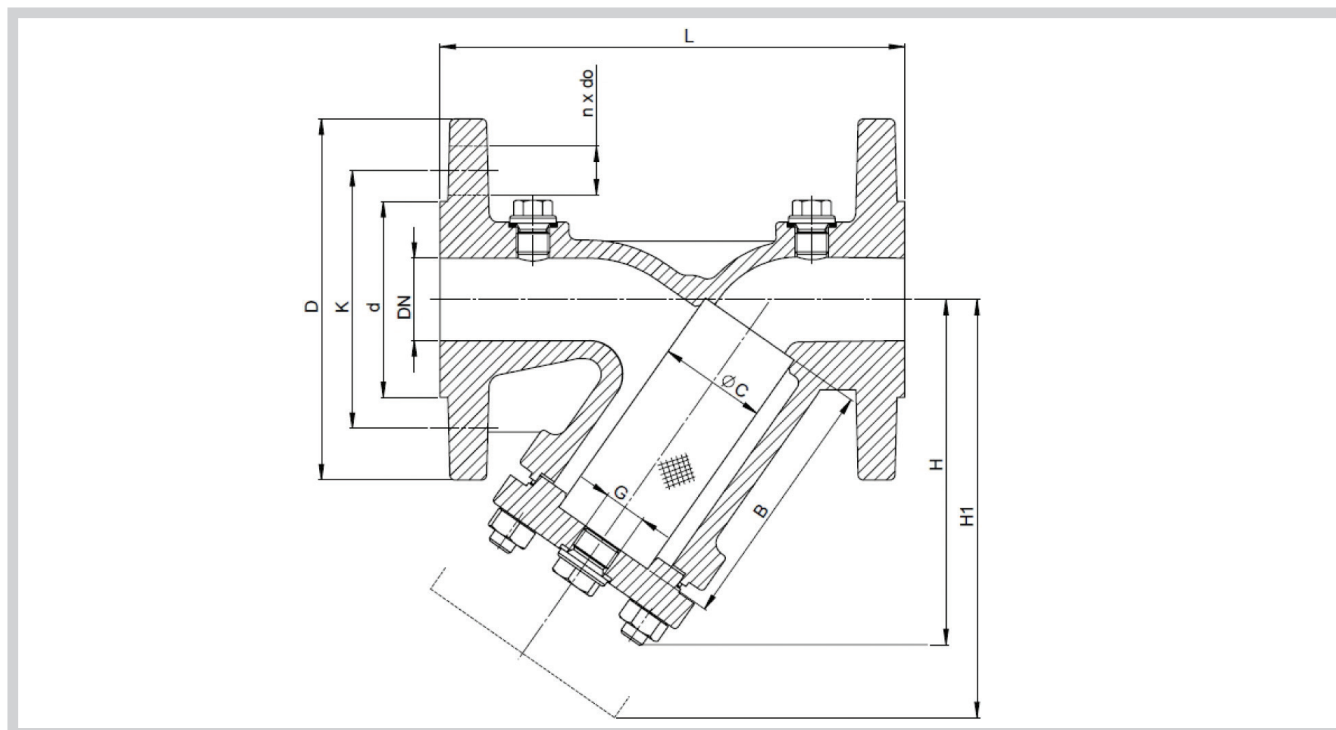

								Type M-F821A, PN 16					Type G-F821C, PN 25					Type H-F821F, PN 40				
DN	L	H	H1	G	C	B	K _v	D	d	K	n x do	Weight	D	d	K	n x do	Weight	D	d	K	n x do	Weight
mm	mm	mm	mm	mm	mm	mm	m ³ /h	mm	mm	mm	mm	kg	mm	mm	mm	mm	kg	mm	mm	mm	mm	kg
15	130	90	135	3/8	23	56	5,7	95	46	65	4x14	2,6	95	46	65	4x14	2,6	95	45	65	4x14	2,7
20	150	100	150	3/8	28	68	10,4	105	56	75	4x14	3	105	56	75	4x14	3	105	58	75	4x14	3,6
25	160	115	180	3/4	36	82	16,4	115	65	85	4x14	4,3	115	65	85	4x14	4,3	115	68	85	4x14	4,5
32	180	135	215	3/4	42	98	27,3	140	76	100	4x19	6,8	140	76	100	4x19	6,8	140	78	100	4x18	6,3
40	200	150	240	1	50	114	42	150	84	110	4x19	8,8	150	84	110	4x19	8,8	150	88	110	4x18	8,7
50	230	160	250	1	61.5	119	64,7	165	99	125	4x19	11	165	99	125	4x19	11	165	102	125	4x18	11
65	290	180	285	1	78.5	134	98	185	118	145	4x19	14,6	185	118	145	8x19	14,6	185	122	145	8x18	18,5
80	310	215	330	1	89.5	149	149	200	132	160	8x19	18,6	200	200	160	8x19	18,6	200	138	160	8x18	23,5
100	350	235	365	1 1/2	109.5	169	234	220	156	180	8x19	27	235	235	190	8x23	27	235	162	190	8x22	33
125	400	280	425	1 1/2	137.5	199	376	250	184	210	8x19	38,5	270	270	220	8x28	38,5	270	188	220	8x26	54
150	480	320	480	1 1/2	160	224	454	285	211	240	8x23	54,5	300	300	250	8x28	54,5	300	218	250	8x26	75
200	600	405	610	1 1/2	210	284	853	340	266	295	12x23	110	360	360	310	12x28	110	375	285	320	12x30	137