

Pneumatic actuators type APD, double acting For 3-way valves type G3FM-T

6.5.11-A

GB-1

Design

Actuators are made by the best manufacture experience on design, material, machining and assembly to meet the demands of the powerful low frequency vibration environments in marine installations.

The internal rotation adjusting system is free of side-loads on pistons, shaft and body at every feeding pressure.

APD pneumatic actuators are compact and reliable.

Easy assembly.

Mounting

For mounting and starting up, the instructions delivered with the actuator must be followed carefully.

Service

No special service is needed.



Technical Data

Body	ASTM 6063 extruded aluminium, 50 micron anodized
Piston	ASTM B179 die-casted aluminium alloy, 15 micron anodized
Cover	ASTM B179 die-casted aluminum painted with polyester powder
Screws	Stainless steel, AISI 304 (A2)
O-rings	NBR
Springs	Pre-compressed Catridges, polyester painted
Grease	Molibdenum Bisulphide
Actuat. flange	ISO 5211
Air supply	Dry or lubricated filtered compressed air, non aggressive gases
Temperature	-20°C to +80°C (optinal: +150°C)
Feeding pres.	6-8 bar continuous
Rotation range	90° ± 5°

Specifications

Type	Max. torque (NM) feeding pres. 6 bar	Valve Dimensions DN in mm	Connections / Dimensions (mm)							
			Bottom connection	Top connection	A	B	C	P	N	O
APD-160	710	G3FM-T DN 200-250	F10/F12 □22	130 x 30 (139 x 22)	462	196	176	50	27	36
APD-180	958	G3FM-T DN 300-400	F10/F12 □27	130 x 30 (139 x 22)	472	220	196	50	32	42
APD-200	1333	G3FM-T DN 450	F10/F12 □27	130 x 30 (139 x 22)	575	240	220	50	32	42

NB: For G3FM-T DN 500-600 please contact Clorius Controls A/S.

Dimension sketch

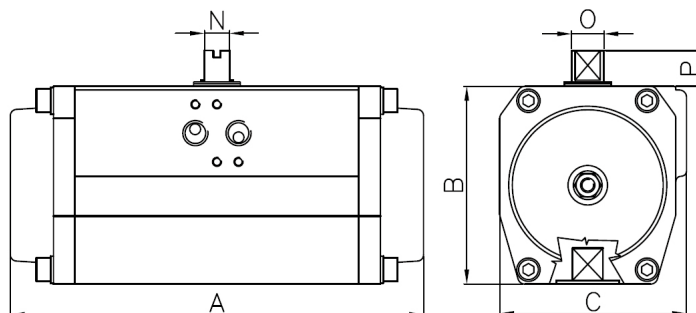

Subject to changes without notice.